

SECTION B-B
SCALE 1/4

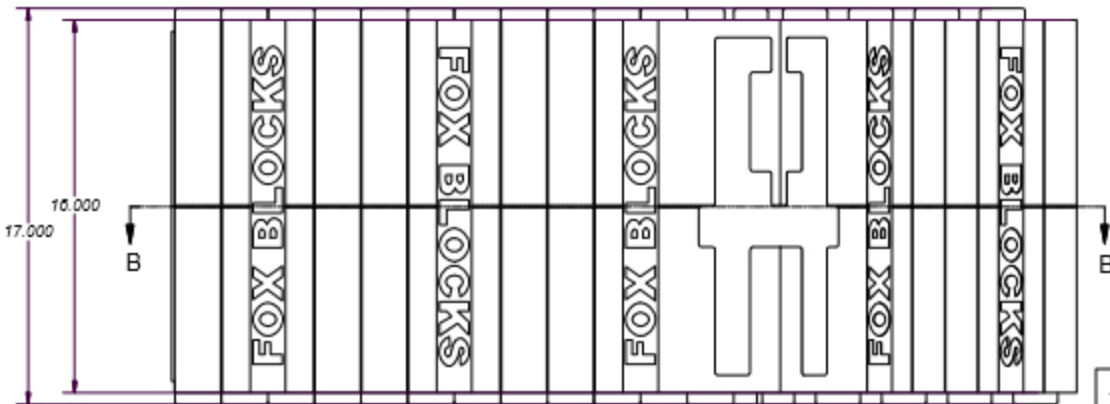
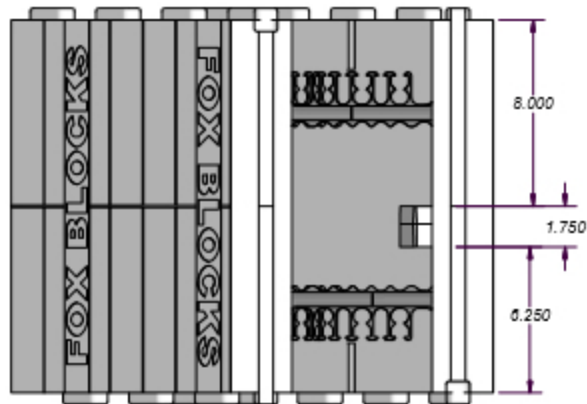
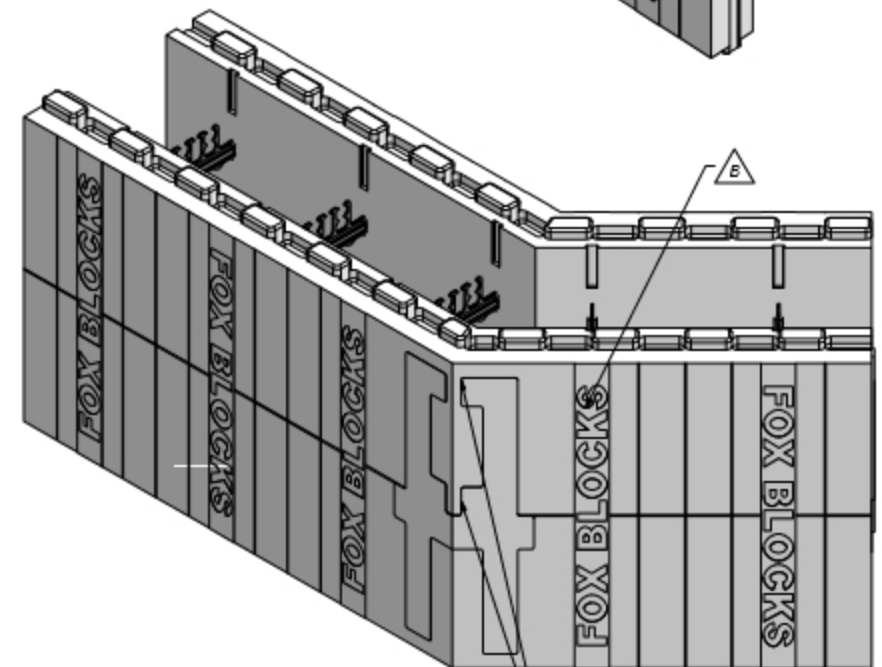
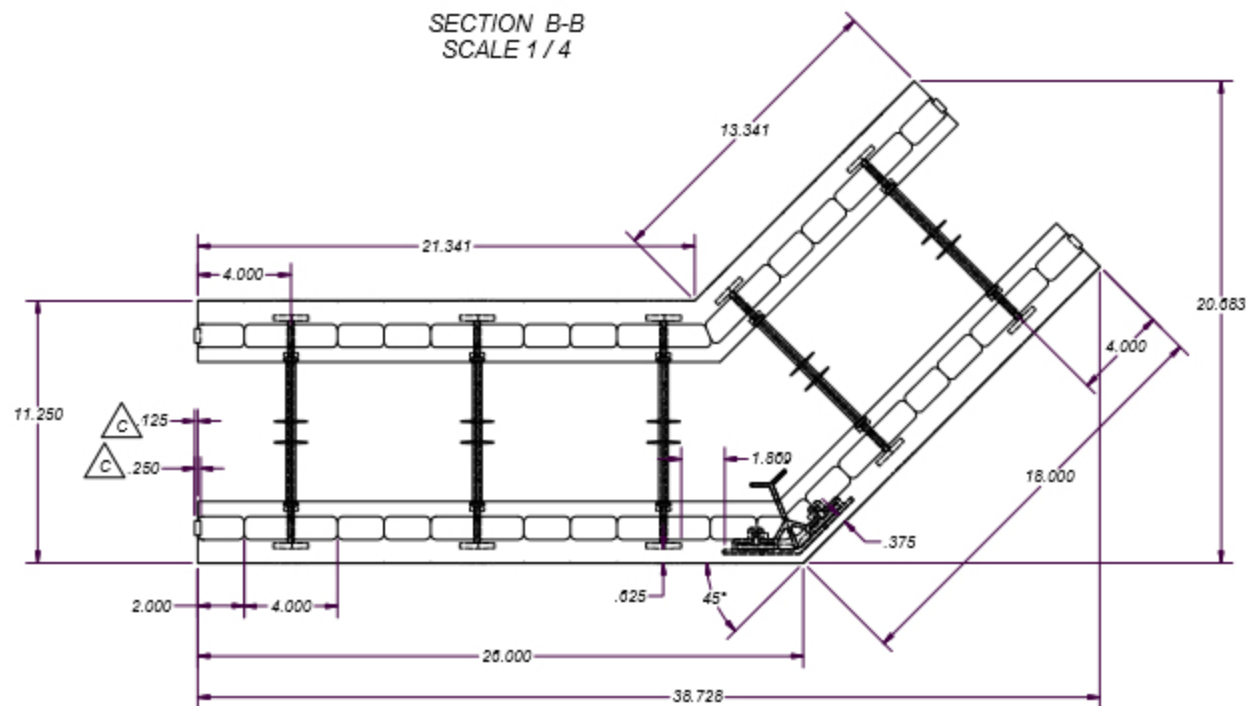
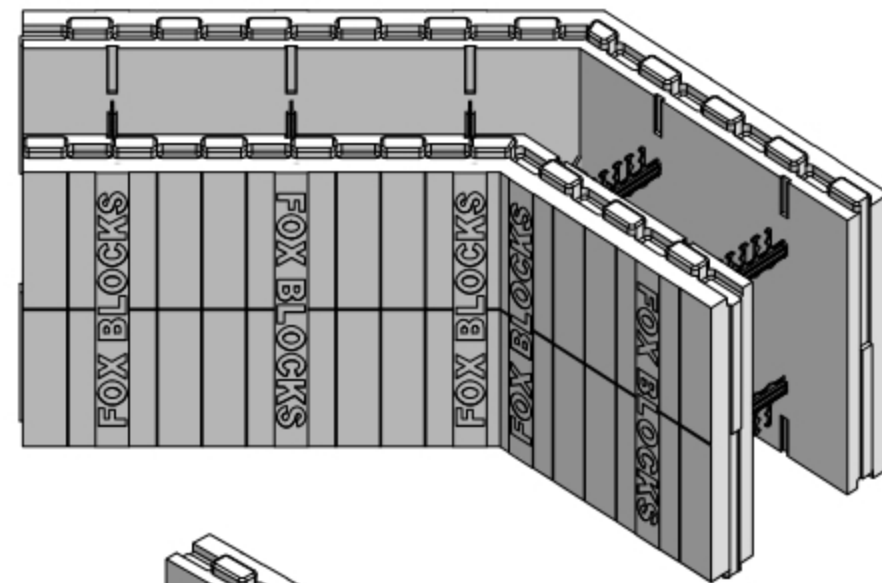

REV	DESCRIPTION	BY	DATE
A	REMOVED MATERIAL FOR BRACKET HINGE	J.B.	8/22/2005
B	ADDED BLOCK NAME	J.B.	9/6/2005
C	.250 was .125 .125 was .063	J.B.	2/22/2008

THIS DRAWING, INCLUDING THE INFORMATION IT CONTAINS, IS THE PROPERTY OF AIRLITE PLASTICS COMPANY. THIS DRAWING IS LOANED STRICTLY ON THE CONDITION THAT IT WILL NOT BE REPRODUCED OR COPIED IN ANY MANNER, AND THAT THE INFORMATION IT CONTAINS WILL BE USED SOLELY IN CONNECTION WITH WORK BEING PERFORMED FOR, OR SPECIFICALLY AUTHORIZED IN WRITING BY, AIRLITE PLASTICS COMPANY.

AIRLITE PLASTICS COMPANY © 2004

DRAWN Jefm	DATE 4/12/2005
SCALE None	GAP
VOLUME	WALL THICKNESS
DISPLACEMENT	SWIRLAGE
WEIGHT	1.01 cu. ft. of EPS
MATERIAL E.P.S. P.P.	

Airlite Plastics Co.
6110 Abbott Drive, Omaha NE 68110-2805

6" ICF angle wall form

NOTES / COMMENTS: CUSTOMER
Fox Blocks
DWG NO
Assembly7 angle v1g